

PEM Electrolyzer Fuel Cell

Product Ref No.: (FCSU-010-1)

Specifications:

- High performance PEM electrolyzer fuel cell
- Dimensions (w x h x d): 54mm x 54mm x 17mm
- Total Weight: 69.7grams
- Color: Blue

Electrolyzer function:

When applying an electrical current (solar or DC power), the electrolyzer produces hydrogen and oxygen from water.

- Input Voltage: 1.8V ~ 3V (D. C.)
- Input Current: 0.7A
- Hydrogen production rate: 7ml per minute at 1A
- Oxygen production rate: 3.5ml per minute at 1A

PEM Electrolyzer- User Directions

Preparation of the Electrolyzer and Solar/Battery Powered Hydrogen Production

1. Place the Electrolyzer onto a flat surface. Cut 2 x 4cm length pieces of rubber tube and insert a black pin into the end of one tube. Place the tube with the black pin into the top pin on the hydrogen side (with black terminal). Place the other tube firmly onto the top input nozzle on the oxygen side (see A).

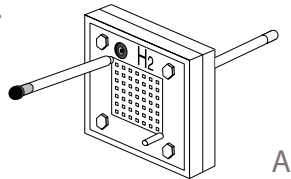

2. Fill the syringe with DISTILED water. On the red (oxygen) side of the electrolyzer, connect the syringe to the uncapped tube. Fill the electrolyzer until water begins to flow out of the tube. Place a red plug into the short tube located on the Oxygen side of electrolyzer. Let settle for 3 min (see B).

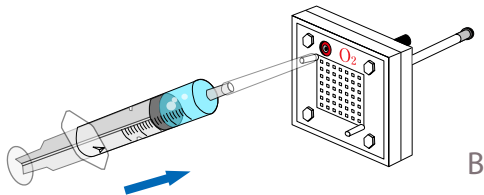

3. Place the outer water/gas containers onto a flat surface. Fill with distilled water up to the "0" line.

4. Place inner containers into outer cylinders minding that the gaps are not blocked by inner plastic rims. Make sure the water is still level to the "0" line. If not, remove some water with the syringe so that water level is at "0" line. Cut out two 20cm lengths of tubing.

5. Connect the tubes to the top nozzles on the inner containers. If the tubing is connected to the inner cylinders lastly there will be no air trapped inside the inner containers.

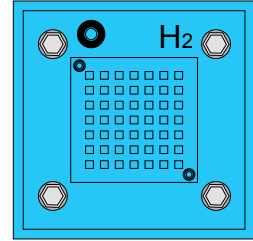

What is included:

- PEM Electrolyzer Fuel Cell

What you need:

- Battery pack or solar panel
- Distilled water
- Tubing
- Pins
- 2 x banana cables/ Connecting Leads
- Syringe
- Water/Gas Containers

6. Connect the other end of one of the tubes to the bottom end of the black hydrogen side of the electrolyzer. Connect the end of the other tube to the bottom end of the red oxygen side of the electrolyzer (see C).

7. Connect the electrolyzer to the solar panel using the corresponding cables and expose to direct sunlight. You can also use a Horizon battery pack and two AA batteries to connect to the electrolyzer as well (see D). (Important: make sure connections are correct or permanent damage can occur.)

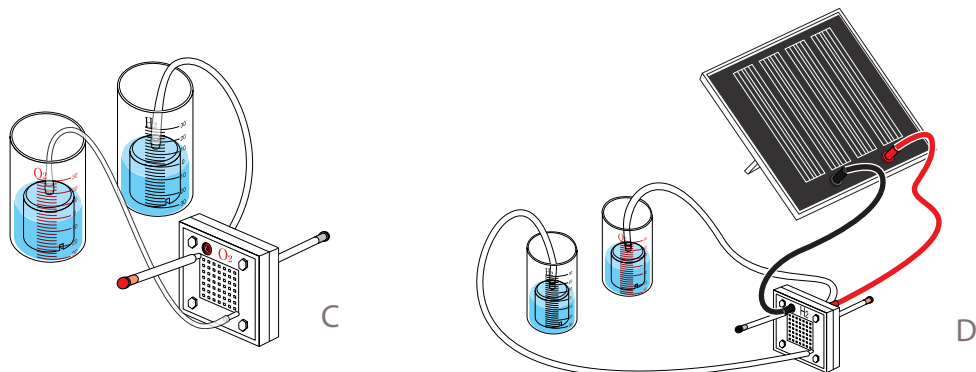

8. If the solar panel is placed in sufficiently strong sunlight, or battery pack is switched to the "On" position the system will now start to produce oxygen and hydrogen in the respective cylinders. When bubbles begin to surface in the hydrogen cylinder the cycle is complete. Disconnect the solar panel or battery pack from the electrolyzer.

Procedure for repeated gas production: Disconnect the small plugs from the tubes connected to the nozzles on the electrolyzer. This will allow water into the inner cylinders to replace the gasses and reset water levels to "0" line. Re-insert the plugs into the tubes and repeat electrolysis again.

* The attached gold leads included with the PEM Electrolyzer and PEM fuel cells may be inserted into red/black terminals of the fuel cells if attaching other devices such as solar panels and small wind turbines using crocodile clip type leads/ cables. These may be also used to attach various loads to PEM fuel cells. We alternately provide 1 set of red/black 2mm banana plug leads/cables with each PEM electrolyzer and fuel cell that are designed to connect to Horizon solar panels and educational wind turbines.

Important:

- It is highly recommended to place the PEM electrolyzer fuel cell inside an air-tight plastic bag, such as a "Ziploc Bag." This will protect it when you are not using the kit.
- The positive and negative poles of the PEM electrolyzer fuel cell must be correctly connected to the power supply or damage may result.
- The membranes in the PEM electrolyzer fuel cell are to be used only when they are hydrated. Inject water only into the positive (oxygen) side of electrolyzer and allow to soak for 3 minutes. The membranes will be damaged if connected to a solar panel or power supply when dry.
- It is highly recommended to use 3 W solar panel with 1A current or 2 new AA alkaline batteries with 1.5V as a power supply.

Note:

You can purchase the components used in the operation online from <http://www.horizonfuelcell.com/store.htm>